

Summer 1978

Elvis First Memorial

PHOTOGRAPHIC PILGRIMAGE TO GRACELAND

Vol. I

1. J. D. Sumner & the Stamps Quartet at Gold Dust West Casino in Reno, Nev.
2. 1973 Lincoln Continental at casino during presentation of "Memories of our friend"
3. Certificate of Title to Lincoln Continental presented as a present to J. D. Sumner
4. Private Coach of Stamps Quartet with T.C.B. insignia ("Taking Care of Business")
5. McCarran International Airport in Las Vegas, Nevada
6. Hilton Hotel (formerly International Hotel), where Elvis performed.
7. Elvis's name on Hilton sign advertising Dec. 2, 1955 performance.
8. Aladdin Hotel where Elvis got married to Priscilla on May 1, 1967
9. North side of Aladdin Hotel.
10. Johnny Harra at Silverton Hotel & Casino (dubbed "Elvis Double")
11. "Prince of Rock and Roll" Rick Sussolo with the Jordanaires and D. J. Fortune
12. Summer Tanager (red bird) - symbol of spirit of Elvis
13. The Red Bird reappears again and again!
14. Killeen, Texas, where Elvis lived while serving at Ft. Hood.
15. 2nd Armored Division (Museum) Ft. Hood. (Headquarters)
16. "Hell on Wheels" insignia with lightning bolt at museum.
17. Troops quarters at Fort. Hood (example of type Elvis lived in)
18. Memphis Airport - landing zone for Elvis's trips back to Graceland
19. Memphis Airport with Tennessee flag (description)
20. "Elvis" red van photographed 7/20/78 at T.O. Fuller State Park in Memphis
21. Loew's Palace - theater where Elvis worked as an usher in 1950.
22. Kinsky Men's Fashion Store - 2nd & Beale Sts - Elvis bought clothes here.
23. Nathani Nowick's Pawn Shop at 142 Beale St, where Elvis bought his first guitar
24. Beale Street, "Home of the Blues"
25. W.C. Handy Park - in tribute to composer of "Memphis Blues"
26. 185 Winchester St - Lauderdale Courts - public housing project and home of Elvis
27. St. Jude Children's Research Hospital - Elvis donated \$100,000 a month here
28. St. Joseph Hospital - Elvis's mother Gladys worked here.
29. 371 Carroll St. - Presley's first rented apartment in Memphis
30. L.C. Humes High School - Elvis graduated from here in 1953. (major - shop, history)
31. L.C. Humes High - back side, where Red West befriended Elvis against football attacker.

1. Gold Dust West Casino in Reno, Nevada located on 4th & Vine. Featuring J.D. Sumner & the Stamps Quartet -- "Memories of our friend Elvis" (also Ferlin Husky with pre-show). J.D. Sumner was absent due to open heart surgery; Ed Enock led the group with his baritone; Buck sang tenor; Larry sang bass. Recording available of show; bought picture of Elvis with J.D.

Elsa and I saw the 9:00 P.M. show on July 8, 1978.

2. 1973 Lincoln Continental watched closely by casino security guard. The car was a present given by Elvis to J.D. Sumner & the Stamps Quartet. Tennessee license number 575 205-XT. (32=5, number of Elvis's name).



5. McCarran International Airport in Las Vegas, where Elvis landed to play at the famed International Hotel (known also as Hilton Hotel).



6. Picture taken in 1975, Thanksgiving week-end. Hilton Hotel, where Elvis first performed in 1969. Flags in front of Hilton:



7. Picture also taken in 1975 when Elsa and I went to see Ann-Margret, the female entertainer who starred with Elvis in the movie "Viva Las Vegas". Coming right after her is ELVIS on December 2, 1975. Globe between 3 white columns - Hilton trademark



8. Aladdin Hotel
in Las Vegas.
Location where
wedding ceremony
of Elvis and
Priscilla took
place at 9:41 A.M.
on May 1, 1967.

Notice Aladdin's
lamp on top of the
sign. Aladdin is
a boy from the
"Arabian Nights"
who is able to ~~cau~~
cause one genni to
appear and do his
bidding whenever
he rubs a magic ~~pa~~
lamp, and another
whenever he rubs
a magic ring.



9. Aladdin Hotel
(northern side).
Gold reflection
from the sun.

Aladdin is located
on east side of
"The Strip".



10.

Glen Pace
Enterprises
Presents:
Elvis' Double
JOHNNY HARRA
with Elvis'
Original
Conductor
Bobby Morris &
Orchestra
at
Major Riddle's
SILVERBIRD
Hotel & Casino



11. "Prince of Rock and Roll" Rick Saucedo presents "Elvis, the Legend Lives" with Elvis' own original Jordanaires (featuring Ray Walker) and D.J. Fontana (Presley's drummer of 16 years). I got a chance to meet Ray Walker and the Jordanaires, along with D.J. Fontana backstage in between shows on opening night, July 11, 1978. I found out the Jordanaires had been singing with "their new-found friend" since January. Completing the original Broadway cast of 22 are impersonator Dominic DeCesare, the Ambassadors, the Sweet Kharisma (resembling Elvis's group, the Sweet Inspiration) and the Elvis Presley Tribute Orchestra. Starring at the Stardust Hotel (Convention Center). Rick Saucedo was dressed in a white jump-suit with a blue Star of David, with blue stones, on his back. He also had a blue scarf around neck.



12. Summer Tanager (red bird) - first seen in Traveler's World Campground in San Antonio, Texas; the color red was a favorite color of Elvis. Elsa had a dream of Elvis that same night (Elvis wanted to travel with us).



13. On top of a barbecue pit - red summer tanager; symbol of Elvis in Spirit.



14. Town of Killeen, Texas, where Elvis stayed during his basic training at Port Hood (2 miles west), from March 28, 1958 to Sept. 19, 1958 (Friday to Friday). Note right side of street--old "Blue Moon" restaurant, looking eastward. Elsa and I stayed at the Killeen Motel (Paul Jr. was with us on this trip!)



15. Headquarters 2nd Armored Division - Gaffey Hall (Bldg. No. 919 - Section 4)



16. 2nd Armored Division Museum at Ft. Hood (Bldg. No. 418 - Section 3) on Battalion Ave. This was where Elvis was assigned to A Company, Second Medium Tank Battalion. Note painting on the wall, the same as worn as a patch by Elvis, designating slogan "Hell on Wheels" and using lightning bolt (which Elvis later adopted on TCB necklace).



17. Building such as one Elvis lived in while on post, before moving into town of Killeen with parents. Note painting with "Hell on Wheels" and five white "Pillars of Hell" supporting the tank insignia.

MEMPHIS - named
after
Egyptian city
of
MEMPHIS



18. Memphis Airport, where Elvis landed many times and from which he took off many times.

19. Memphis Airport. Note Tennessee flag in right foreground with red, white and blue colors...a red field upon the centre of which is a blue circle edged with white and which contains three white five-pointed stars. At the fly end is a blue stripe separated from red field by narrow white stripe.





20. On July 20, 1978 at 3:30 P.M. at T.O. Fuller State Park (southwest Memphis) I met Al Cehfus from Syracuse, New York. Al had purchased an "Elvis" van from Rodco in California for \$15,000. License number 396-SXR. The van was a showcase van, and the salesman sold it unintentionally. He was fired immediately after making the gross mistake. Al Cehfus has been offered \$50,000 for the van, and he of course has turned it

down, saying that he was going to keep in shining it in Elvis's memory. He has shown the van to numerous fans in front of Graceland; his son even profited from the venture by allowing Elvis fans to take pictures for \$1.00. Both sides of the van are decorated with Elvis singing in a dark blue sky surrounded by twinkling stars, golden disks, musical notes, and red flaming colors of the gorgeous van. Al considers himself to be very fortunate; he's a sincere Elvis fan (he wouldn't even visit the gravesite because he wants to remember Elvis alive, not dead); he keeps the van as clean as possible out of respect for the King.

21. Loew's Palace - theater on Union St. where Elvis worked as an usher in 1950. Not used presently.

He didn't work there very long because he got fired. The reason he got fired was because he got into a fight with another usher over the girl who worked the popcorn machine.

He was a typical boy.





2. Lansky - Men's Fashion Store - corner of Second St. and Beale St. where Elvis used to buy his fancy clothes. Elvis as a child was a dreamer, and one of the places he liked to do his dreaming was here. He'd go inno Lansky's and see all those beautiful suits and things that he couldn't afford. Finally, they ended up loaning him money so he could buy his first suit there. Elvis repaid their generosity in later years when he got rich by buying lots of clothes from them.



23. Nathan Nowick's Pawn shop at 142 Beale St., where Elvis bought his first guitar. Nathan can tell you all about that episode. Elvis bought his first guitar here for \$10.00 when he was eleven years old. The man who sold Elvis the guitar is named Lew.
24. Famous Beale Street, the "home of the Blues," where W.C. Handy composed his famous "Memphis Blues" and "St. Louis Blues." Elvis roamed down this street listening to the sounds of blues music. The most famous spot on Beale Street is Pee Wee's, where W.C. Handy wrote his first notes of blues music.



25. W.C Handy Park -
 statue of W.C. Handy
 (William Christopher)
 - he is holding a
 trumpet
 - located on 3rd and
 Beale STS.



26. 185 Winchester Street,
 Lauderdale Courts -
 Elvis lived here in
 1949 on the ground
 floor. Notice the
 door in the middle.

It's got a 32 above the door. Presleys lived on the first floor four windows to the left of that door. Their original address was 432 Exchange. They lived here from the time Elvis was thirteen to after he graduated from high school. Notice the window farthest on the left (the smallest one)--that was the most important place in their apartment. That was their bathroom. In their previous home they shared a bathroom with six other families. And here they had their own bathroom. Lauderdale Courts is the first public housing project in Memphis. It was a public housing project when the Presleys lived here. In fact, at one time they were told they had to leave Lauderdale Court. What happened was Gladys had gotten a job as a nurse's aide, and the Presleys were making just a little bit above the amount they could live in here for. So the government told them to leave. They found out their rent would be much higher in the other places they could move to, and they actually would be getting further and further behind. Elvis commented on this: "You can't get ahead no matter how hard you tried. They just wouldn't let you." Gladys ended up giving up the job so they could go back to Lauderdale Court.



27. St. Jude Children's Research Hospital - a world-famous hospital for children with catastrophic diseases. Notice the statue of St. Jude in the middle; it stands for "lost cause and hope." Danny Thomas, who's the founder of St. Jude, says: "There is no lost cause or hope." What they do here is treat a child for two-and-a-half years, and over 80% of these children (those treated for leukemia) have completely recovered from acute leukemia. Elvis Presley donated \$100,000 every month to this hospital!



28. St. Joseph's Hospital - the place Gladys Presley worked in as a nurse's aide. And it is that very job she had to give up, because she'd come in from working at night and say how tired her feet were.

29. 371 Carroll St.

When the Presley's came from Tupelo to Memphis they couldn't find any adequate housing at all. And for two months they ended up living in this house. It is here where they shared a bathroom with six other families. Fortunately they only had to live here for two months.



30. L.C. Humes High School - where Elvis attended grades 7-12, graduating in 1953. (Now known as Humes Jr. High.) Appearance of a fortress, with red brick and four cupolas on top. Saying on right-top of building: "The whole world here unlocks the experience of the past to the builders of the future." Saying on left wall: "The hope of democracy depends on the diffusion of knowledge and wisdom." Located on Manassas. Elvis said that the very first day he walked into this building he felt like the hairs on his head were standing on end because he was a country boy that had come to a city school and he was totally scared to death.



31. Back of L.C. Humes High, on Woodlawn St., where Red West defended Elvis from attackers. (Red West now plays Sgt. Miklin on "Baa Baa Black Sheep" with Robert Conrad). Two footballers attacked Elvis.

VOL. II - Photographic Pilgrimage to Graceland

32. B & H Hardware, 353 Poplar St. (formerly Crown Electric Co.)
33. Sam Phillips Recording Studio at 639 Madison St.
34. Original Sun Recording Studio at 706 Marshall St.
35. Baptist Memorial Hospital on Monroe St. - Elvis died here on Aug. 16, 1977.
36. Vernon Presley's home on 1266 Dolan St.
37. Vernon's driveway, garage, and cars.
38. "The Wall of Love" around Graceland
39. Writings on "Wall of Love"
40. Souvenir Shops across the street from Graceland
41. "Souvenirs of Elvis" - souvenir shop
42. Gates of Graceland
43. Vester Presley - Elvis' uncle and gate guard at Graceland
44. Thunderbird enters gates of Graceland
45. Guest car leaving gates & souvenir hawkers
46. Vernon Presley in Grand Marquis
47. Vernon's Mercury enters gates
48. Driveway leading to mansion
49. Graceland.
50. Trophy Room - poolside.
51. Swimming Pool.
52. Meditation Garden. (from pool)
53. Meditation Garden. (from pool)
54. Meditation Garden. (through walkway)
55. Fountain in Meditation Garden.
56. Statue - outstretched hands of Christ
- 57-8. Glass mural windows with religious themes
59. Elvis Presley's Tombstone with inscription
60. Floral ornaments around Elvis' burial site
61. Floral ornaments around Elvis' burial site
62. Burial site of Gladys Love Smith Presley - mother of Elvis
63. 10-foot Presley Tombstone (cross, Christ & two angels); also statue of Mercury.
64. In front of Graceland mansion
65. In front of Graceland mansion
66. In front of Graceland "musical" gates
67. Pink "Free Bus" to Elvis Presley (G) Ranch
68. Elvis Presley (G) Ranch, on Goodman Rd., Walls, Mississippi
69. Elvis' Honeymoon Cottage at (G) Ranch
70. Showcase of Elvis memorabilia in museum at (G) Ranch
71. Showcase (con't)
72. Elvis and Priscilla's honeymoon cottage bedroom
73. Clubhouse, lake and swimming pool at (G) Ranch
74. Elvis memorabilia at club house.



32. B&H Hardware, 353 Poplar St. - used to be Crown Electric Co., place where Elvis worked as a truckdriver.

One of Elvis's dreams in life was to become a truck driver like his father. He decided he wanted to do that right after high school. Little did he really know what fate had in store for him. He worked at a place called the Crown Electric Co. B&H Hardware is the very site of Crown Electric Co., and it is in that very building where Elvis worked as a truckdriver. In fact, he was working there when he recorded his first single. When he finally decided to give up his job as a driver in order to play at various clubs around the mid-south, his father Vernon said he was a nut to give up such a superior job as truck driving in contrast to going into such a risky job as music was.



33. Sam Phillips Recording Studio at 639 Madison St. Sam was the man who helped Elvis get his start in the record business. Sam Phillips Recording Studio as it is seen today is on Madison St.; the original Sun Recording Studio is now Uniserv, a Auto body shop on 706 Marshall St. What happened was that one day in August Elvis walked into Sun Recording Studio to record a disk as a birthday present for his mother. He paid \$6.00 for the disk. Well, at that time Sam Phillips was looking for a white singer with a black man's voice. Marion Keisker, the secretary, thought that she found what Sam was looking for when she found Elvis Presley. So she spent \$24.00 on a tape of Elvis, but she forgot to get his name or his address. Well, a year later Elvis came back to record a disk as a birthday present to Red West, and about a week after that the Blue Mountain Boys (Scotty Moore, Bill Black, and Elvis) were in the studio recording Elvis's first hit single, "That's All Right, Mama" (the same sound he sang for his mother Gladys a year earlier in the same studio).



34. Original Sun Recording Studio at 706 Marshall St., and now known as Uniserv Auto Body Shop.

The Beatles and the Rolling Stones both say that without Sam Phillips and his studio they wouldn't be where they are today. Rock 'n' Roll became popular right behind his studio doors. And Elvis was the spark that lit the fire!

Also Johnny Cash, Charlie Rich, Jerry Lee Lewis, and a whole lot of other performers have gotten their start from Sam Phillips.



35. Baptist Memorial Hospital on Monroe St. Gladys, Elvis's mother, died here on August 14, 1958 at the age of 46. Lisa Marie, Elvis's daughter, was born here on Feb. 1, 1968. Elvis Presley was pronounced dead on arrival here on August 16, 1977.

Baptist Memorial Hospital is the largest private hospital in the world. It has 5,000 beds in it. In fact, it's so large they even had to have their own zip code. It was the hospital where Elvis spent a lot of his time, especially in the latter part of his life. He even had a private suite rented so he could come there and recuperate from total exhaustion.



36. Vernon's home on 1266 Dolan St. (behind Graceland). Located in the Graceland subdivision. These houses were begun in 1959. After Elvis come back from the army and after his father Vernon married Dee (with her three small boys), Elvis decided it would be better for all concerned if Vernon and his new family had their own home. Elvis told his father that he'd buy him any home in the Graceland subdivision that he wanted. All he had to do was pick one out. Vernon picked out the home on 1266 Dolan in 1960. Vernon still lives here today (although presently he and Dee are divorced). He's been living here for 18 years now. You can get to Graceland from Vernon's back yard. In fact, Elvis did it many times when he didn't want to be recognized by his fans. This is also where Priscilla Presley lived when she went to high school here in Memphis.
37. Vernon's driveway and garage with his own Mercury Grand Marquis parked in it (license number 1-PO568). Other cars parked in the popular driveway, a Thunderbird, 1-CL655; another car, 1-FF084; and a Chevrolet, 1-J716-0.





38. "The Wall of Love" around Graceland. On this wall are written the most eulogizing words about a king -- all out of respect and love by his innumerable fans. There is not one derogatory remark on it out of all the writing on it.



39. Close-up of "Wall of Love," looking into Elvis's horse-riding arena, an enclosed grassy slope where Elvis rode his horses (one of which was named Sun).

WRITINGS ON "WALL OF LOVE"

- (5) Elvis - like magic you made us feel alive
- (6) No stage will ever shine so bright
No voice will ever sing and bring the joy you brought
You'll always be the King.
- (7) God Bless You, Elvis
- (8) There will never be another Elvis
- (9) Elvis - a god among men...

- (1) I miss you Elvis, and I still love you.
- (2) ELVIS - A man is never dead until his memory dies;
He will remain immortal in our hearts.
- (3) I pray you will rest in peace until the trumpet calls; your throne will always remain for all time; we love you and little Lisa
- (4) We will always remember you

40. Souvenir shops across the street from Graceland:

- (1) Souvenir's & Boutique
- (2) Elvis Record Store
- (3) "The King in Concert" (1st Memorial Anniversary show, featured at a four-pillared building with a crown on top - slide presentation with Elvis music) -- Adults \$1.50, Children \$1.00
- (4) Most of the stores in this small shopping center were converted into souvenir shops shortly after Elvis's death (others will follow)



41. Directly across from the Gates of Graceland (a most coveted position) is the brick shop "Souvenirs of Elvis" (completed shortly before 1st Mem. Ann.). Behind and to left is "Elvis Jewelry Store". 3 blocks north is souvenir shop "Eternally Your's" on 3489 Elvis Presley Blvd.



42.

GATES OF GRACELAND

A wide walkway allows souvenir shoppers safe passage via a lighted "walk" signal. A special intersection complete with lights (red, yellow, green) insures safe passage inside the musical gates adorned with Elvis's gyrating-singing figure. Fans constantly cluster in groups in front of the gates as if expecting some special grace to be bestowed upon them. Note one overhanging lamp, which is used to light the way through the gates at night (also for security reasons).



43. Graceland Gate GuardVester Presley

Elvis's uncle, Vernon's brother.

A poster on Vester's guard window advertises his newly published book about his nephew, Elvis, entitled A Presley Speaks, sold for \$10.00 (regular copy) or \$25.00 (deluxe special edition, gold trimmed and autographed copy).

Incidentally, Vester sent out bulk rate letters to Elvis's fans around the country advertising his book. Caption on front of envelope: "But I not only loved Elvis, I knew him."

Address: Vester Presley, c/o Wimmer Brothers Books, P.O.Box 540, Memphis, Tenn. 38101

44. Thunderbird (1-CL655) entering Graceland gates. (Note photo 37 where this car was parked next to Vernon's car).



45. Special guest car leaving Graceland (1-CG499).
Note: souvenir pamphlets are distributed when exiting; customers are lured to souvenir shops with "free souvenirs" (ex. Marriage Certificate, Meditation Garden, Elvis's Burial Site and engraved eulogy written by Vernon Presley)

46. Vernon Presley, father of world-famous Elvis Presley, at the wheel. A momentous picture?!





47. Mercury
Grand Marquis
(1-PO568),
Vernon's car,
enters
GATES
of
GRACELAND

48. Driveway (and
walkway) leads
to Graceland
Mansion &
Meditation
Garden.
Maple, magnolia
and oak trees
adorn the
green grounds
of Graceland.



49. Graceful and
majestic four
pillared ante
bellum mansion
of Elvis is
guarded by
two stone
lions. Road
curves left
to mansion &
right to
Meditation
Garden (also
burial site).





50. View of Elvis's trophy room overlooking poolside. Cast-iron chair and table, statues, marble plant stands, cast-iron rails & window guards. Background right is a bathhouse.



51. Kidney-shaped swimming pool with three steps on northern side (foreground); lounge chairs around pool; background - double men's and women's bathhouse

52. Looking southwest toward Meditation Garden. Semi-circular eight-pillared overhang



53. From trophy room
down
brick
steps
to Meditation
Garden.



54. View of Medita-
tion Garden
from swimming
pool area.
Looking through
brush-bordered
walkway.
Note beautiful
pink crepe
myrtle tree in
left background.



55. Fountain in Meditation Garden;
ever-flowing water.
What kind of one-fingered and
two-fingered sign is this
three-year-old boy giving with
his downcast fingers? Is he
trying to somehow imitate in his
own awkward way the message of the
outstretched hands of the background
marble figure in front of the cross?
Eastward view of fountain and statues
of Christ and Mercury.

56. Statue of Christ with outstretched hands in front of burial sites and final resting places of Elvis and his mother Gladys. Is that three-year-old boy crying because he doesn't want to believe that Elvis, the King, is really dead?



57. Glass mural windows with religious themes adorn the brick walls, which serve as southern boundaries of the Meditation Garden. These two windows are on the eastern side of the wall and overlook Gladys's grave.

58. Western windows with religious murals overlooking Elvis's burial site. Note missing light fixture in brick wall.



9. Elvis Presley's burial site with cross (at northern head), which has smiling picture of Elvis and three red roses on it, and with Vernon's eulogy on the tombstone. The eulogy begins with the words: "He was a precious gift from God we cherished and loved dearly," and it ends with the words: "We miss you, Son (from Vernon) and Daddy (from Lisa Marie). I thank GOD that he gave us you as our son." Note: Elvis's middle name is spelled Aaron, the biblical way, instead of Aron, the way it appears on most documents. Born January 8, 1935. Died August 16, 1977. Age 42. (9,3,6=numerology). Tombstone inscription is cast in a 400-pound coffin length bronze plaque. It is attached to a 2000-pound granite slab which covers the grave of Elvis. Vernon Presley received the inspiration to write the eulogy one morning at dawn when he was awakened by the bright rays of the sun streaming through his window. The words came to him in a rush from his subconscious mind. What he wrote seems to be a beautiful example of automatic writing:



He was a precious gift from God
 We cherished and loved dearly.
 He had a God-given talent that he shared
 With the world. And without a doubt,
 He became most widely acclaimed;
 Capturing the hearts of young and old alike.
 He was admired not only as an entertainer,
 But as the great humanitarian that he was;
 For his generosity, and his kind feelings
 For his fellow man.
 He revolutionized the field of music and
 Received its highest awards.
 He became a living legend in his own time;
 Earning the respect and love of millions.
 God saw that he needed some rest and
 Called him home to be with Him.
 We miss you, Son and Daddy. I thank GOD
 That He gave us you as our son.



60. Floral ornaments surrounding Elvis's burial site; blue arrangement with famous T.C.B. insignia and lightning bolt (meaning "Taking care of business in a flash"); biblical one with page of Psalms 23 -- "The Lord is my Shepherd;" heart with red roses; guitar with orange and white roses; cross with red roses. These arrangements seemed to be permanently placed because they were plastic and not real.

61.

More floral arrangements beside Elvis's western burial site which spilled over onto Gladys's eastern burial site (on right hand of son); guitar with blue and yellow daisies; heart with white roses and /red roses dividing the heart in two; blue heart with T.C.B.; round white rose arrangement upon a circular blue disk with silver lettering "Moody Blue;"



62. Burial site of Elvis's mother, Gladys, beside Elvis at Meditation Garden. Gladys Love Smith Presley. Born: April 25, 1912, Died: August 14, 1958. Age 46. (Many books, magazines, and newspaper articles erroneously quote Gladys's age at death as being 42, probably an attempt at making both mother and son dieing coincidentally at 42). Inscription by Vernon Presley: "She was a great person, a great wife and mother. She was also loved by many. We loved her dearly and she is sadly missed."



God's Garden

The kiss of the sun for pardon;
The song of the birds for mirth;
One is nearer God's heart in a garden
Than anywhere else on earth.

- Dorothy Francis

63. Ten-foot Presley tombstone, Cross, risen Christ and two angels. It was originally placed at Forest Hill Cemetery Mid-Town. Symbolical heart is placed on chest; hands out-



stretched as if to say; "Come unto me all ye that labor and are heavy-laden and I will give you rest;" two angels, symbolical of angels present at Christ's resurrection; acronym Ihs means "In His Service;" all this is made of white marble. Statue to right of PRESLEY tombstone is a white marble statue of Mercury, the messenger of Zeus (Jupiter), in a Roman outfit, with winged sandals, a winged low-crowned hat, and other accoutrements of the graceful and swift-of-motion god.

64. In front of Graceland, home of King Elvis. "Keep Out" sign posted on yellow nylon rope. Two white marble lions guard the four-pillared stone mansion of ante-bellum design. Shutters are part of the design. Cast iron in front of windows were installed for security reasons.



65. Author of pilgrimage with son at Graceland. /Ante-bellum -- Greek revival architecture was the fad of the day during the nineteenth century in the South. Southerners as a whole didn't have much of their own history, so they identified with Greek history and its grand architecture, which included tall pillars, which were used in Greek temples. As a general rule, Southern architecture was eclectic-- a lot of things from various cultures mixed together./

66. In front of Graceland gates, made from white cast iron and painted with green trimmings; includes Elvis-with-guitar figures and musical notes; the two halves of the gate swing inward and form a symmetrical whole.
 CE D A (Do Me Re La)
 SE AG (So Me La So)





67. Pink "Free Bus" across the street from Graceland. It will take you to the Elvis Presley Circle (G) Ranch. Or you may choose to follow the suggestion on the back of the bus: "Follow me to Elvis Presley Ranch." (License number BC 0187)

Entrance Fee: \$2.00 a person.



68. Elvis Presley Circle (G) Ranch sign at entrance on Goddman Road. Directions: Go 5 miles south of Graceland to Goodman Rd. and 4 1/2 miles west to ranch (enter on left hand side just before reaching Hwy. 301). Located on Horn Lake exit. Address: Elvis Presley G P.O. Box 1000 Graceland-Walls, Mississippi
Phone: (601) 781-1482 (fan club)
Phone: (601) 781-0243



69. Elvis's Honeymoon Cottage, now museum sponsored by the Graceland Fan Club. Note four pillars at front entrance of brick cottage, which seems to be a miniature replica of sorts of Graceland mansion; green shutters on the windows are similar also.



70. Showcase of Elvis memorabilia in museum; (left) 45 magnum guns; E.P. initials wallet; turquoise bracelet; watch and gold T.C.B. necklace; concert belt; macramé and beads belt; 45 record; kerchief with E.P. initials; autographed Elvis Presley blue scarf.



71. Showcase (right); identification tags; tinted prescription glasses; Indian-design choker; Elvis buttons; Elvis-in-concert picture; concert belt; racquet ball set.



72. Elvis and Priscilla's honeymoon cottage bedroom.



73. At the ranch: a club house, swimming pool, lake, oriental bridge, stables, and lots of land. Pink, spanish-style club house. View from dirt road south-east of museum.

74. Elvis memorabilia at club house: portrait of Elvis, prehistoric bird jumpsuit, dresses worn by Priscilla, framed picture of youthful Elvis, and a couple of Elvis's belts. Newspaper clipping in club-house; from Memphis Press-Scimitar, dated Feb. 5, 1955 and titled "Suddenly singing Elvis Presley zooms into recording stardom."



75. El Camino Ranch Wagon Chevrolet 327 displayed in its blue splendour outside entrance to club house. Bought: Feb. 16, 1967. Address: Rt. 9, Horn Lake, Miss. Dealer: Hoehn Chevrolet Co., 367 Union Ave., Memphis, Tenn. Serial number: 136807K141530

75. El Camino Ranch Wagon Chevrolet 327 at Ranch club house
76. Elvis' Honda motorcycle at Spanish-style club house
77. Elvis' white Continental at club house ("gift from the Colonel")
78. Stables and 50 feet memorial cross at ranch
79. Elvis Presley Blvd. (South Parkway intersection)
80. Statue of St. Paul at Forest Hill Cemetary
81. Forest Hill Mid-Town Mausoleum - former bural site of Elvis
82. Former burial site of Gladys Presley at Forest Hill
83. Libertyland, amusement park in Memphis
84. Map of Libertyland
85. "Zippin Pippin" roller coaster at Libertyland
86. 1034 Audubon Dr, where Elvis lived in 1956
87. "Memphian" - the theatre Elvis loved"
88. Blackwood Bros, Inc. Records, 211 Lauderdale
89. Overton Park Shell
90. Overton Park - statue of soldier
91. Immaculate Conception Cathedral High School - Priscilla's alma mater
92. Karate School of Self Defense - Elvis studied Karate here under Master Rhee
93. Trip to Tupelo - scenery (Japanese Kudsu vine)
94. "Welcome to TUPELO" sign
95. Main St. Tupelo
96. Sign: "Elvis Aaron Presley Memorial Highway"
97. Intersection - Main St.E. and Elvis Presley Rd., Tupelo
98. Elvis Presley Park (with map of neighborhood)
99. Sign: Birthplace of Elvis Presley
100. Birthplace - humble two-room shotgun house
101. Bedroom.
102. Kitchen.
103. Back view of birthplace.
104. Miniature model of Graceland (in Presley Center)
105. Proposed plans of Elvis Presley Chapel
106. Plaque and pulpit at Tourist Center
107. Elvis Presley Park, 306 Elvis Presley Rd.
108. Top of the hill behind birthplace
109. Baseball Field at Elvis Presley Park
110. First Assembly of God Church on 206 AdamsSt.
111. Original church which Presleys attended on 909 Berry St.
112. Mrs. Faye Harris at 207 Adams St.
113. 904 Kelly St. - Elvis lived here as a boy
114. Priceville Cemetery - burial site of Jesse Garon Presley
115. Lawhon School on 140 Lake St. - Elvis went to school here
116. Milam Jr. High School, 720 W. Jefferson - Elvis went to school here
117. Tupelo National Battlefield Site
118. Bourbon St., New Orleans - location of Elvis' movie "King Creole"
119. Fairmont Hotel (formerly Roosevelt) - Elvis stayed here
120. Lake Pontchartrain, New Orleans - on location filming of "King Creole"
121. Fort Lauderdale - on location filming of "Girl Happy"
- 122-3. Fontainebleau Hotel, Miami, Florida - Elvis performed here in 1960
- 124-6. Smoky Mountains, North Carolina and Tennessee - Elvis' favorite park
127. Smoky Mountains Bear.
128. Beautiful Laurel Falls in Smoky Mountains, Tennessee
129. Gatlinburg Wax Museum featuring new in '78 Elvis
130. Elvis impersonation by Don Hinton in Pigeon Forge, Tennessee
- 131-2. Country Music Hall of Fame and Museum, Nashville, Tennessee
133. WALKWAY OF STARS - Elvis Presley's name appears in gold lettering below a five-pointed star design.



76. Elvis's motorcycle on display, western side of clubhouse; Honda motorcycle, license number ZN-3516, Tenn 1975

77. Elvis's white Continental on display, eastern (right) side of building; "a gift from the legendary manager" Colonel Parker; mileage 73367; automatic, air conditioner, electric windows.



78. Stables and 50 feet tall white memorial cross looking northwest.



79. Elvis Presley Blvd. and
South Parkway intersection;
Bellevue Park in background.



80. Statue of St. Paul at Forest
Hill Cemetary, on left side
of road past main office (in
Section 31A) on the way to
Gladys' and Elvis' former
burial sites. Note; hand
sign, extended index finger,
was a sign used (with both
hands raised) by Elvis.
Statue is purported by some
to be controversial figure
of Appolonius of Tyana, and
his index finger points up-
ward to the ONE Sun "that
is the light of the world"

FOREST HILL MID-TOWN
1661 Elvis Presley Blvd.
Memphis, Tenn. 38106
(901) 775-0310



81. Four-pillared beige abbey-type mausoleum in Section 14 (southwest corner) of Forest Hill Mid-Town Cemetery, where Elvis was carried up 4 steps to be entombed in a six-crypt family room of Corridor Z to the right of the foyer. A bronze ornamental door opened into the gray marble crypt. A black curtain covered the crypt opened for Elvis. Elvis was buried in a white suit, with dark blue tie and light blue shirt that his father gave him as a Christmas present. On his finger was a ring with the letters "TCB" and lightning bolts on either side. He was moved to Graceland at 7P.M. on Oct. 2, 1977.



82. Former burial site of Gladys Presley in Section 9 of Forest Hill Mid-Town. A flower draped knoll where Elvis's mother's monument (removed to Graceland) stood in a pine grove. A standard-size marker had been placed about five feet in front of Christ and the Cross monument reading: Gladys Smith Presley, April 25, 1912-Aug. 14, 1958; "Beloved wife of Vernon Presley and Mother of Elvis Presley, She was the Sunshine of Our Home." Elvis frequently visited this site while alive. Scars were left when moved 10/2/77.

83. Libertyland, amusement park in Memphis, located at Mid-South Fairgrounds on East Parkway. Elvis frequently came here. He apparently last came here with fiancée Ginger Alden and nine-year-old Lisa Marie on Aug. 7, 1977 (or Fri. the 4th?). The theme park is divided into 3 theme lands: Colonial Land, Frontier Land, and Turn-of-the-Century Land. Address: P.O. Box 14808, Memphis 38114. Phone: 274-1776. Admission: \$5.50/under 3-



84. Fourteen rides rip and roar all over Libertyland, where the slogan is: "Something for everyone at Libertyland." Nine shows, lots of shops, over 100 different ways to dine and snack, pet and feed the animals, meet Libertyland's own Hound Dog--all at Libertyland in Mid-America. Erected 1976, Bi-Centennial.

Use your ticket stub for a **FREE TOPS BAR-B-Q** SEE BACK

85. "Zippin Pippin" roller coaster at Libertyland--Elvis's favorite ride at Memphis' amusement park. It features four cars per coaster. Behind the roller coaster is Mid-South Coliseum, where Elvis performed for his Memphis home-town fans.



86. The house on Audubon DR. a street of beautiful homes, where Elvis lived in 1956 after receiving national acclaim and lots of money. The address was 1034 Audubon Dr., between Park Ave. and Haverhill R. on the east side; the green and white (in '56) house was bought for \$40,000. A year later Elvis sold the house for \$55,000, after adding a two-car garage in back and an iron fence surrounding the entire property. The dozen big trees added to front yard enhance view for present owner, Ted Chandler.



87. MEMPHIAN - "The theatre Elvis loved and used for his private screenings." Formerly known as Suzore No. 2. Tribute to Elvis Week, Aug. 18-24, 1978. Elvis movies advertised at front (posters): Easy Come, Easy Go; Double Trouble; Clambake Live a Little, Love a Little. Located on west side of Cooper St. at Union Ave. (272-9604)

88. Blackwood Bros. Inc. Records, 211 Lauderdale (between Poplar & Exchange). This was the quartet Elvis wanted to sing with before his own star began to rise. As the story goes, the B.B. had a member who thought he was gonna leave but then changed his mind. Elvis was disappointed. In later years he went on to acquire three other gospel quartets to sing backup for him: Jordanaires, Imperials, Stamps. Blackwood Brothers also sang at Gladys Presley's funeral service; they sang "Rock of Ages" and Mrs. Presley's favorite, "Precious Memories."





89. Overton Park Shell - an open air theater in Overton Park between Poplar Ave. and Kenilworth St. Elvis performed here at an all country music show early in his career. He sang the song: "Good Rockin' Tonight"

90. Overton Park - statue of WWI soldier with bayonet rifle; in honor of all soldiers who serve their country (Elvis served 1958-60). Background - police strike gathering on Aug. 16, 1978 (National Guard patrolled the streets during the week-long strike).



91. Immaculate Conception Cathedral High School - Priscilla went to school here during her early years with Elvis. Located on 1725 Central Ave. Phone: 276-6341.

92. Karate School of Self Defense, which Elvis attended as a pupil. Former instructor of Elvis, Kang Rhee, a 7th degree black belt, is the chief instructor at the Kang Rhee Institute also known as the Oriental Center where "Karate is taught as an art in the traditional Oriental manner." Promotion is based on points and techniques with speed, coordination, balance, focus, timing, confidence, discipline, attitude and manner, etc. progressing through white belt, yellow, green, blue, purple, brown, red, and finally black belt 1st degree through 10th degree black belt. Inside the center are pictures of Elvis with instructor Kang Rhee. A special patch that Elvis wore included his familiar TCB and lightning bolt insignia surrounded by words: Faith, Spirit, Discipline. Address: 1911 Poplar Ave. Memphis 38104 Phone: 726-4100

(located across the street from Overton Park entrance)



Memphis to Tupelo - 107 miles



93. Trip to Tupelo, Mississippi, birthplace of Elvis Presley, via Hwy. 78 (in Memphis city limits it's called Lamar Ave.) heading southeast. Hwy. 78 begins at Tennessee-Mississippi border. Along the ride south are the unique and interesting "natural" designs created by the rapidly spreading kudzu vines. According to a State Forest Ranger at Tombigbee State Park (9½ miles SE of Tupelo), the Japanese kudzu vine was imported from Japan to contain and control erosion. But the bugs that were needed to control the vine growth couldn't be imported since they also eat cotton. As a result, the vines are covering the rees and destroying them.

94. "Welcome to TUPELO" sign at northern outskirts of city on H.78



TUPELO: named for the tupelo gum tree. Located on the first concrete road in the South. Original TVA city. One of the first industrial cities in Mississippi. Home of Private John Allen (Sign on H.49)



95. Main St. Tupelo (E78, E6), looking toward East Tupelo, the site of Elvis Presley's birth. Note: hill in background with water tower, which looks like a silver golf ball on a tee; Elvis Presley Drive is just before that hill and tower. (We stayed at the All-American Motor Inn).

96. Sign at intersection of Elvis Presley Rd. (formerly Old Saltillo Rd.) and Main St. E.; "Elvis Aaron Presley Memorial Highway. The Mississippi portion of U.S. 78 between Tenn. and Ala. is dedicated to his memory. Born: Tupelo, Miss. Jan. 8, 1935, Died: Memphis, Tenn. Aug. 16, 1977." (@ 131 miles dedicated to Elvis's memory).





97. Intersection - Main St.E. and Elvis Presley Rd. Four-way signal. Road south is Briar Ridge St(H.6) which leads to Tombigbee State Park. Across street (south side) is "Tupelo Son" a souvenir shop owned by Mrs. Billie Boyd. Signs direct Elvis devotees to birthplace, open daily. Up Main St.E. (north side) is E.P.Heights SuperMarket and E.P.East Heights Restaurant. Further up the hill is the water tower.

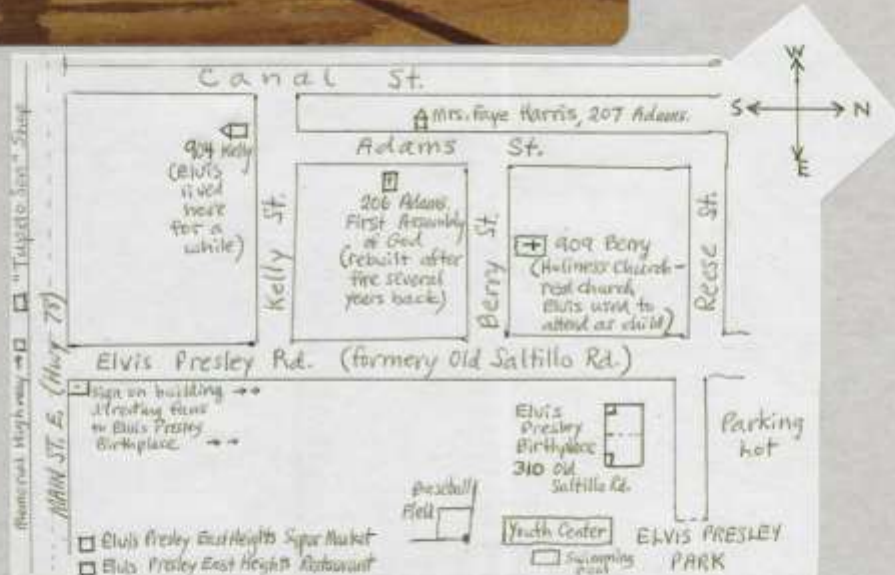

98. Elvis Presley Park (15-acre park site). White clapboard shotgun house is supported by East Heights Garden Club. Elvis' first home is now opened from 2-5P.M.daily and 25¢ admission is charged. E.P.Youth Center is behind birthplace; it has a souvenir shop and a large hall where some meetings are held. House on east side; entrance-w.





99. Sign:
 Birthplace of Elvis Presley. Elvis Aaron Presley was born Jan. 8, 1935, in this house, built by his father. Presley's career as a singer and entertainer redefined American popular music. He died Aug. 16, 1977 at Memphis, Tennessee.



100. Swinging porch chair adorns the birthplace of Elvis. Remodeled steps (four) and wooden hand rails lead the tourist-fan into the past, back to 1935, when Elvis was born in the humble two-room house. "The house itself has not been changed since Elvis' father, grandfather and uncle built it in the 1930's." (Tupelo Daily Journal)



101. The bedroom is the 1st room that tourist enters. Left to right: old radio on wooden stand; cast iron bed; lamp behind bed; hand-carved wooden rocking chair; dresser & mirror; fireplace and mantel; picture of three-year-old Elvis with parents; and a tiny picture of a guardian angel leading a child as the visitor goes through door into kitchen-dining room. Note: pretty pink & red flowers with green stems wallpaper.



102. Kitchen: back of brick wall to which is attached cast-iron Franklin stove on four legs; small wooden chair; antique cupboard; kitchen table complete with vinyl table cloth to match diamond-shaped gold wallpaper; old porcelain stove. One light fixture with a long string provides light from center of ceiling.



103. Back view of shotgun house with three doors and six windows. Fans are urged to use front entrance. Across street is St. Mark United Methodist Church. A hexagon purplish-pink aura resides in the tree overlooking the birthplace, a symbol of the number 6, number of Gladys' name and birthdate.



104. Miniature model of Graceland. Located in Presley Center (also known as Tourist Information Center-Gifts/Souvenir Shop/Memorabilia/Collectables). Earlene Hall--cashier. Graceland from left to right: den; main mansion; music room; trophy room; swimming pool; meditation garden. Surrounding the model is white fence along sides and back, and the wall of love with musical gates in front.

105. Proposed plans of Elvis Presley Chapel by Johnson and McCarty, P.A. Architects and Planners, Tupelo. Proposed chapel to be built on present site of baseball field (which is to be moved north of birthplace--across Reese St.) Light in middle of picture symbolizes the light of Elvis.



106. Plaque above pulpit in southwest corner of souvenir shop; Graceland Mansion--Home of Elvis Aron Presley--Made and donated by Vincent P. Ducote, New Orleans, La. 1978.

Pulpit from First Assembly of God Church of Tupelo. Elvis and his parents attended this church during Elvis' early years. Donated to the Elvis Presley Memorial Foundation in behalf of the congregation by Brother Dean Tilley. Given Jan. 8, 1978.

107. Elvis Presley Park
306 Old Saltillo (E.P.)
(601)842-9796

Looking westward
from the hill
behind the birth-
place.

Swimming pool;
\$1.05 adults
.53 child
(tax included)
Park also has;
tennis courts
baseball field
swings



108. At the top of the
hill behind birth-
place is the creek
and small lake in
a wooded area where
Elvis used to play
as a boy.



109. The baseball field,
facing southwest,
where the proposed
Elvis Presley Chapel
is to be built.



110. First Assembly of God Church on 206 Adams St. Phone: 844-5841. Pastor: Brother Dean Tilley. Located on east side of Adams between Reese and Berry. Church was reconstructed several years back (according to Mrs. Faye Harris) because of fire.



111. Original church which Presleys attended; now sitting on 909 Berry St. (north side). Originally named Holiness Church and pastored by Rev. Gaines Mancel (pastor at time of Elvis' boyhood).

112. Mrs. Faye Harris at 207 Adams St. (across from 1st Assembly). She's an old friend of Gladys Presley. I interviewed her on Sunday, July 23, 1978. Phone: 842-3813. She said: "Adams St. was named for her father." About Gladys: "She didn't put much confidence in the church." About 1stAG: "The same spirit isn't there as in the beginning."



113. 904 Kelly St. - Elvis lived here as a boy for a while (on south side). Located between Adams & Canal.



114. Priceville Cemetery - location of Jesse Garon Presley's burial site. Twin brother of Elvis. Unmarked grave in unmarked cemetery on Feemster Lake Rd. (east and north of E.P. Dr. on H. 78 - first stoplight to left). Directions: from birthplace to Main St. 2/10 mi.; from E.P. Rd. to Feemster Lake on Main St. E. 9/10 mi.; from stoplight on Feemster to cemetery 7/10 mi. Located across street from Priceville Baptist Church. Dirt roads inside

The story has been told that when Elvis' twin brother died at birth, a tiny casket with the body was set beneath the window on the trunk (that Vernon still has, and which belonged to Gladys), for mourners to pay tribute to. (Tupelo Daily Journal).



115. Lawhon School on 140 Lake St. (turn right just before E.P. Rd. going east on Main St. Elvis went to school here as a kid. Phone: 844-1542



116. Milam Jr. High School,
720 W. Jefferson (north
side) - corner of Gloster &
Jefferson.
Elvis went to school here
before moving to Memphis.
Principal (842-2491)

117. Tupelo National Battlefield Site, U.S. Dept. of Interior
National Park Service (W. Main St. & Monument St. -
south side of Main).

Central Monument says:
IN MEMORY
OF THE MEN OF THE
FEDERAL AND
THE CONFEDERATE
ARMIES
WHO TOOK PART IN
THE BATTLE OF TUPELO
OF HARRISBURG
JULY 14-15, 1864
WHICH RESULTED IN
A VICTORY FOR THE
FEDERAL FORCES UNDER
MAJOR GENERAL
ANDREW J. SMITH



Two cannons - one on left and one on right of central
monument. Left display relates Battle of Tupelo
(military map of the Western Campaign 1864).
Small monument on right says:

TO OUR
CONFEDERATE DEAD
THAT GAVE THEIR
LIVES IN BATTLE
HERE ON
July 14, 1864
FOR THEIR RIGHTS
Erected 1918.



129. Gatlinburg Wax
Museum, at foothills
of Smoky Mountains,
Tennessee.
Featuring new in '78:
Elvis and Jimmy Carter



130. Signs of Elvis in
Pigeon Forge,
Tennessee (between
Smoky Mountains
and Knoxville).
"The Magic of Elvis
by Don Hinton,
Live on Stage."

131. Country Music Hall of
Fame and Museum,
Nashville,
Tennessee.
(on Division St.)



132. Country Music Hall of
Fame (16th Ave. S.--
Music Row).
Address: 4 Music Square E.
Phone: (615) 244-2522
Admission: Adults \$2.50
Child 6-11... \$1.50
5 & under... free
Divided into 25 sections
from #1, parking lot, to
#25, country store.

133. WALKWAY OF STARS

Elvis Presley's name
appears in gold lettering
below a five-pointed star
design.

Bronze and terrazzo
blocks, located in the
lobby (Sec. 3) of Country
Hall of Fame in Nashville,
honor artist of the
country music industry
who have contributed both
time and money to the
Country Music Foundation's
Library and Media Center.
Elvis' name surrounded
by: Ferlin Husky (above),
Sonny James (left),
Glaser Brothers (right),
Roy Orbison (below).



PHOTOGRAPHIC PILGRIMAGE TO GRACELAND
VOL. III

134. Mural of Elvis Presley--9 different poses--at Country Hall of Fame
135. Elvis Presley's "Solid Gold" Cadillac at Country Hall of Fame
136. Ceiling of "Solid Gold" Cadillac with six gold records
137. "Solid Gold" Cadillac interior
138. Music Row Entertainment Center featuring "The Elvis Memorial", Nashville
139. Ryman Auditorium, 116 Fifth Ave., home of Grand Ole Opry (1941-1974)
140. Interior of Ryman Auditorium (stage) - Elvis appeared here in 1954
141. Interior of Ryman Auditorium (auditorium)
142. Nashville State Capitol - Elvis appeared here on Mar. 8, 1961
143. OPRYLAND - Juke Box Theater, featuring Elvis medley of hits
144. Graceland signs on Memphis streets
145. "American Trilogy" billboard (reproduction of Betty Harper's sketches)
146. Betty Harper's illustrations on display
147. Betty Harper's sketches.
148. Elvis Presley Blvd. Inn
149. Chenaults Restaurant - "Elvis ate here"
150. Elvis Poster - "Elvis Presley is a legend--a legend lives forever"
151. Aug. 16, 1978 - 1st Memorial Anniversary of Elvis' passing into spirit
152. Ed Parker, author of Inside Elvis; "Viva Las Vegas" motorcycle; "My Way"
153. Cook Convention Center in Downtown Memphis - Elvis' First Cadillac
154. Cook Convention - Eldorado Cadillac given to Karate instructor Kang Rhee
155. Charlie Hodge - best friend of Elvis
156. "Memorial Field" at Whitehaven High School - Elvis played football here
157. Patricia Stevens Career College & Finishing School - Priscilla went here
158. Mid-South Coliseum at Fairgrounds behind Libertyland - Elvis sang here
159. WMC - "Flagship of the Mississippi" - radio station playing "Elvis Memories"
160. "Elvis Forty-Nine Times" painting by Andy Warhol
161. Orpheum Theater presents "Elvis Lives On" film festival
162. Central Station on 545 Main S., train station where Elvis (dis)embarked
163. Ed Parker speaks at Elvis First Memorial Service "Reflections"
164. Billy Smith in front of 50-foot Memorial Cross (moon reflections)
165. Charlie Hodge at Memorial Service (Elvis TV special reflections)
166. "Little Soldier Boy" at Graceland
167. Threesome at Graceland saying Farewell
168. Hernando Desoto Bridge - the big M span over the Mississippi River
169. Full Circle - in the beginning on Aug. 16, 1977 I was in Hawaii when...



134. Mural of Elvis Presley - 9 different poses - located on wall near Elvis' "Solid Gold" Cadillac in Country Hall of Fame and Museum in Nashville

135. Elvis Presley's "Solid Gold" Cadillac; through technology and taped narration, visitors are permitted to take a look inside this famous automobile. 1960 Cadillac-75. Purchased by Elvis and RCA Records in 1960. License RH-5325. Roof opens up to reveal "gold" interior. Located in Sec.13 of Country Hall of Fame and Museum in Nashville.



136. Ceiling of "solid gold" Cadillac has six gold records attached to it:

1. Don't Be Cruel
2. Surrender
3. I Can't Help Falling in Love With You
4. It's Now or Never
5. Heartbreak Hotel
6. Hound Dog



137. "Solid Gold" Cadillac interior; gold plated television set, 45-rpm record player, gold refreshment bar, 24-karat gold plated trim throughout the car. Solid Gold theme is carried throughout the car, including the gold-and-white upholstery. Gift of Elvis, the Colonel and RCA.



138. Music Row Entertainment Center on 115 Sixteenth Ave.S., Nashville. Down the street west of Country Hall of Fame. Featuring "The Elvis Memorial," a 85-foot mural by Mitchell Torok. A spectacular 30 minute eulogy depicting the life and times of Elvis Presley, with computerized special effect lighting and sound. A must for Elvis fans! Admission: \$2.00 adults.

139. Ryman Auditorium, 116 Fifth Ave.,No. Home of the Grand Ole Opry from 1941 until March 16,1974, when it was moved to Opryland. Admission: \$1.00. Location of Elvis' one time appearance on Grand Ole Opry with Hank Snow back in 1954.





140-141. Interior of
Ryman Auditorium -
Stage and Auditorium



142. Nashville State Capitol -
Elvis appeared before the
Tennessee legislature here
on Mar. 8, 1961. Governor
Ellington presented Elvis
with a Tennessee Colonel's
commission. Elvis closed
his brief talk by saying:
"God bless all of you as
He has blessed me."
Overlooks Memorial Sq.
in downtown area. Located
in its halls of marble and
granite are the offices of
the Governor, key members of
his staff, and the chambers of
both houses at Tennessee's



143. Juke Box Theater at OPRYLAND, Tennessee. Section "Do Wah Ditty City" featuring a group, The Sh Booms, doing impressions of rock 'n' roll artist from the '50's, including songs by Elvis Presley (a medley of hits).

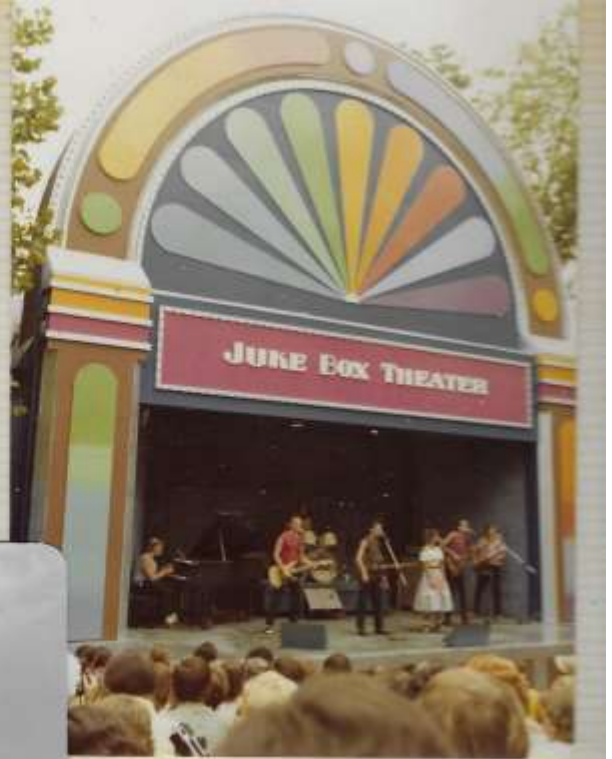

144. Back in Memphis for 1st Memorial Celebration of Anniversary of Elvis' Passing into SPIRIT. New signs adorn the streets of Memphis, showing the pilgrim "the way to Graceland."



145. Billboard across the street from Graceland (west side, south of gates). Betty Harper of Nashville, TN. drew the original "American Trilogy" (an award winner in 1978's Central South Art Exhibit held in Nashville's Parthenon. Billboard, unveiled Aug. 1, 1978, is a 15 by 44 reproduction of drawing showing three phases of Elvis' career
(1) face shot about 1957
(2) dramatic one from 1969
(3) hazy profile from 1974

146. Betty's Harper's illustrations of Elvis on display at First Tennessee Building, 165 Madison Ave., during 1st Memorial Anniversary Week. Betty Harper has captured the mood of Elvis the man and the entertainer in her many illustrations.



147. More illustrations by Betty Harper. Many of them are captioned with a title.



148. Elvis Presley Blvd. Inn, named in commemoration of the King. "Welcome" sign for Elvis fans during 1st Memorial Anniversary Week in Memphis. Located on east side of E.P. Blvd., same side as Graceland.

149. Chenaults Restaurant advertises sign "Elvis ate here." Located on east side of E.P. Blvd.

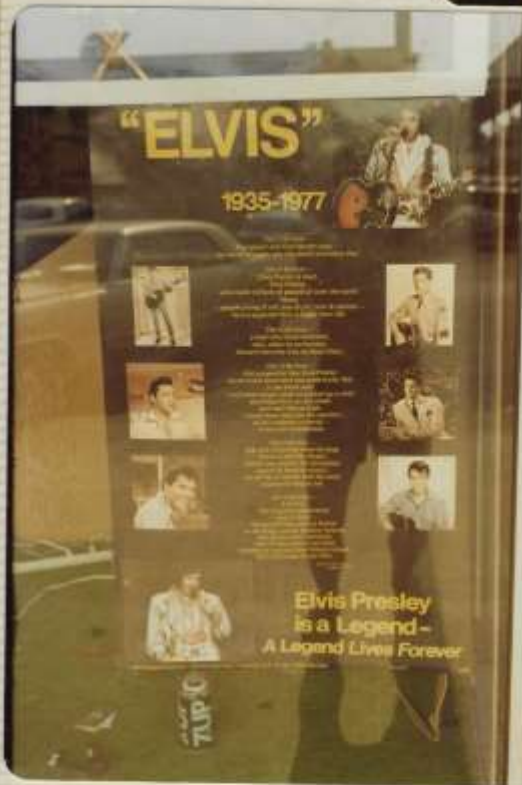

150. Elvis poster with poem adorns souvenir shop across the street from Graceland.
"Elvis Presley is a legend -- a legend lives forever."

151. Aug. 16, 1978 - one year after Elvis died. The crowds throng to the gates of Graceland for a free tour of Graceland mansion and Meditation Garden, where Elvis lies buried alongside his mother. National Guard troops are on duty during the week-long police strike.





152. Across the street from Graceland; Ed Parker, karate instructor and close friend of Elvis for 17 years, and author of Inside Elvis; also Harley-Davidson motorcycle on sale for \$50,000 (Ann-Margret and Elvis rode it in "Viva Las Vegas"; "My Way" by James Neumann

153. Cook Convention Center in Downtown Memphis -- "World's Largest Memorial - Elvis Convention." (Mon. & Tue. Aug. 14 & 15, 1978) Continuous showings of films - Elvis in Concert, etc. Fan clubs and exhibitors from all over the country. Meet Charlie Hodge, singer and best friend, and Dick Grob, head of Graceland security. On display: "Elvis's first Cadillac."



154. Elvis' special made Eldorado Cadillac given to his Karate Instructor Kang Rhee on June 4, 1973. Vernon Presley had purchased the white cadillac, customized with the Continental rear-end and silver front-end grill, for Elvis as a gift. Elvis drove it ten months and then bestowed it upon Master Rhee as a gift. Note: peacock cape on hood. Managed by: Chris Marshon P.O. Box 4287 Memphis, Tn. 38104





155. Friendly Charlie Hodge comes to the Cook Convention Center to take pictures with Elvis fans for \$3.00, complete with polaroid snapshot and autograph.

156. "Memorial Field" at Whitehaven High School, where Elvis played football with his buddies. Located on west side of E.P. Blvd., behind high school, on McClure St.



157. Patricia Stevens Career College & Finishing School on 1853 Madison St. where Priscilla Presley went to finish her education after high school, and before marrying Elvis



158. Mid-South Coliseum at Fairgrounds behind Libertyland.

Elvis performed here for his Memphis fans several times.

159. WMC Radio News- "Flagship of the Mississippi" Radio station devoting lots of time to "Elvis Memories" during 1st Memorial Anniversary



160. "Elvis Forty-Nine Times" by Andy Warhol, painted in 1962; arranged in seven vertical columns and seven horizontal rows; on exhibit at Brooks Memorial Art Gallery in Overton Park





161. Orpheum Theater presents "Elvis Lives On" film festival (disrupted in part by week-long police strike).

162. Central Station (now Amtrak) between Calhoun and St. Paul on 545 S. Main. Passenger station where Elvis embarked and disembarked on his train rides.



163. Ed Parker speaks at the Elvis Aron Presley First Memorial Service "Reflections" on August 16, 1978 at 4:00 P.m. at Elvis Presley Circle G Ranch, P.O. Box 1000, Graceland-Walls, Mississippi. Participants: George Kline, Eddie Poole, Billy Smith, Marty Lacker, C.G. Matthew, Dave Hamlin (rep. Gov. of Miss.) and mayor of Memphis. Presented by Graceland Fan Club. Handouts--Elvis' picture with caption: "Take My Hand Precious Lord"



^{George Klein}
164. Billy Smith, 1st-Cousin and companion, speaks at Memorial Service in front of 50-foot cross.

(Right--across the mountains of Utah the full moon followed us home as Elvis Memorial Week came to a close. I seemed to see a profile of Elvis with sideburns stamped on the face of the moon. The left side of his face seemed to turn slightly in the pilgrim's direction to offer guidance and solace. Thanks, Elvis!)

165. Charlie Hodge (not on original program) appears to speak in Elvis' behalf.

(Picture of Elvis on Ann-Margret presents Elvis Memories, a TV special--the spirit-figure of Elvis seems to faintly fill the screen as the SPIRIT of ELVIS LIVES ON!)





166. "Little Soldier Boy" with "Big Soldier Boy" at Graceland, Memphis.

167. Farewell picture to Graceland and Meditation Garden (final resting place of Elvis).



168. Hernando Desoto Bridge (across the Mississippi River); also known as Hwy. 40. Notice the big M span on top of the bridge; the M stands as a symbol of the majestic and mighty Mississippi River and the marvelous city of Memphis, which brought the magnificent sound of Elvis Presley to the world.

169. Full Circle - where it all began (right after our trip from Hawaii in August 1977, the time of great mourning). It was on Aug. 16, 1977 that I felt a strong psychic attraction toward the spirit of Elvis, and it was immediately afterwards that I started to devote time and effort in carrying on the legend of Elvis.

